



AVAILABLE:

The Subject space is 2,260 SQFT on the ground level and it includes a basement of 2,714 SQFT.

This newly constructed retail development will be delivered in January of 2026.

Join the busy neighborhood of Red Bank retail and shopping districts, which includes The Count Basie Theater, Urban Outfitters, Restoration Hardware, West Elm, Garmany, Tiffany & Co., and other great shopping, along with a multitude of great restaurants.

The subject site is located on a main thoroughfare of Shrewsbury Ave, only 5 blocks from the Red Bank train station, which has a traffic count of 22,600 cars per day.

Seeking a learning center, spa, boutique, salon, medical, eye care, physical therapy, insurance company, or other professional services.

Demographics	1 Mile	3 Miles	5 Miles
Population:	13,373	59,857	127,212
HH Income:	\$153,357	\$208,386	\$202,588
Daytime Pop	21,186	68,470	134,405

Total GLA	Parking
2,260 SF - 4,974 SF including basement space	10 Spaces

Traffic Counts	
Shrewsbury Ave	22,628 Cars Per Day
Monmouth St.	7,147 Cars Per Day
West Front St.	15,933 Cars Per Day

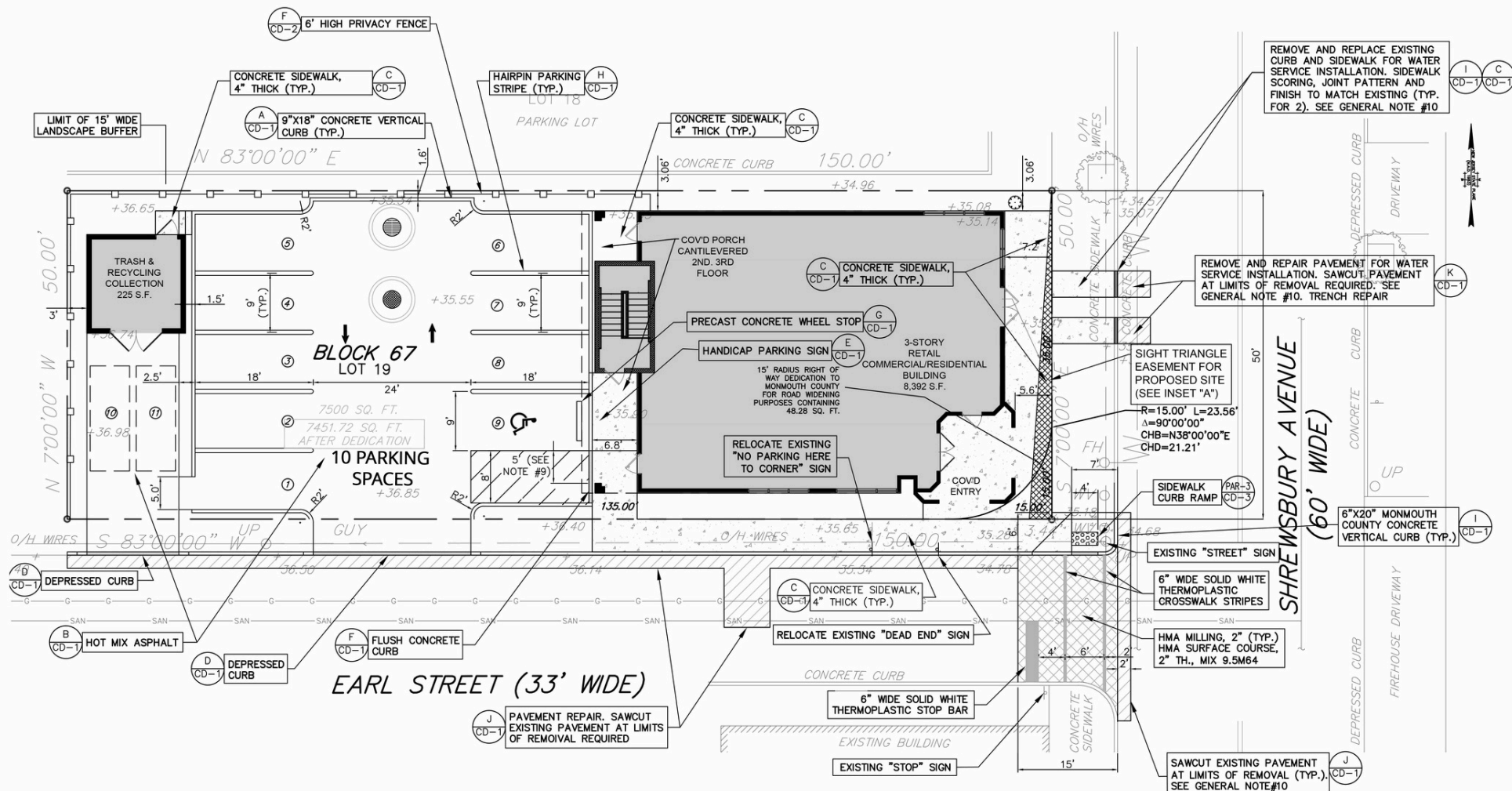







160 Shrewsbury Ave.
AVAILABLE FOR LEASE

CONNECT WITH US TODAY



TONY MEHMEDAJ

tony@rjbrunelli.com
347-725-9930



R.J. Brunelli & Co., LLC,
400 Perrine Rd, Ste 405 Old Bridge, NJ 08857
732-721-5800 www.rjbrunelli.com