FOR LEASE
Verdana Commons
2501 Route 9
Howell, NJ

AVAILABLE:

2,400 SF; 2,300 SF; 18,676 SF; & 10,324 SF

Located at a signalized traffic-controlled intersection on Rt. 9 North with a traffic count of 40,556 cars per day.

Benefit from morning commuter traffic traveling North

Less than one mile from Interstate 195.

127 parking spaces

Restaurant Pad Site opportunities with a drive-thru.

Limited restaurant and retail competition north of Interstate 195.

Located near the entrance to several large underserved residential developments.

Demographics

	1 Mile	3 Miles	5 Miles
Population:	4,469	43,589	97,713
HH Income:	\$117,669	\$144,526	\$142,549
Daytime Pop	3,482	30,028	77,816

Total GLA

33,700 SF

Traffic Counts

 Route 9 40,056 Cars Per Day

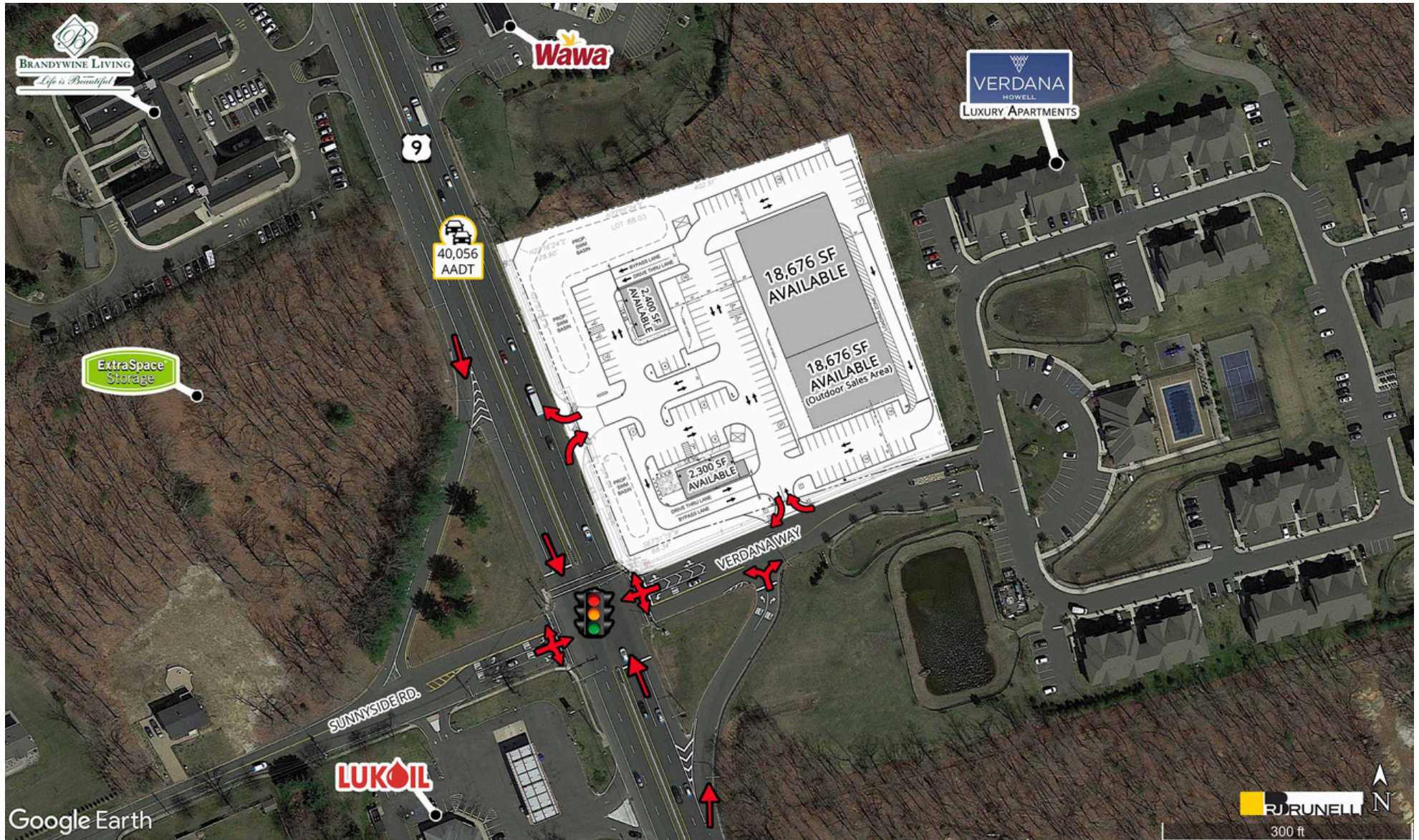





2501 Route 9
AVAILABLE FOR LEASE

CONNECT WITH US TODAY



DAWN PIZZICHILLO

dpizzichillo@rjbrunelli.com
732-939-0730



R.J. Brunelli & Co., LLC,
400 Perrine Rd, Ste 405 Old Bridge, NJ 08857
732-721-5800 www.rjbrunelli.com